

GRASSHOPPER

FOR SALE

PRICE:
£34,995

68ft
 Cruiser Style Narrowboat

6 BERTH



BOAT SUMMARY

A 68ft cruiser-style narrowboat built in 1980 by Hancock & Lane. Replated in 2014, this part-refurbished 6-berth boat is ideal for new live-aboards and is equipped with a BMC 1.8 engine with an open-plan living & dining area, modern bathroom fittings and a large kitchen.

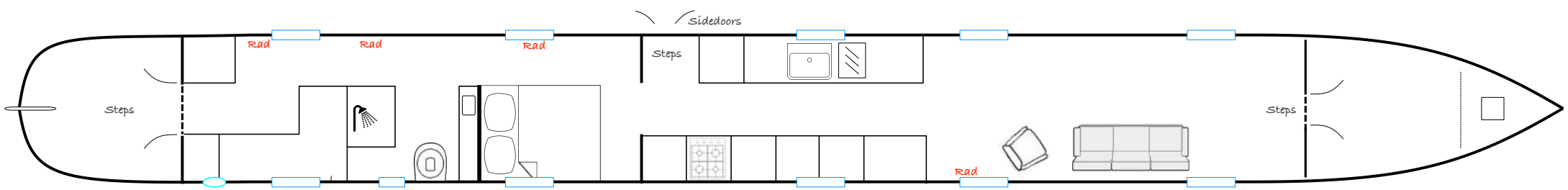

THE ASHBY CANAL CENTRE
 WILLOW PARK
 STOKE GOLDING
 NUNEATON
 WARWICKSHIRE
 CV13 6EU

BRIDGE 26, THE ASHBY CANAL

CONTACT US FOR A VIEWING
01455 212636

SPECIFICATIONS

www.ashbycanalcentre.co.uk

TECHNICAL

- Built in 1980 by Hancock & Lane Boat Builders.
- BMC 1.8 four-cylinder engine with PRM 260 gearbox.
- 45 gallon diesel tank
- Electrics: 12 volt system: 1 starter and 2 domestic batteries
- 1kw Inverter
- Solar panel

MAINTENANCE HISTORY

- Replated in 2014
- BSC: May 2015

HEATING/INSULATION

- Alde water boiler with radiator system.
- Polystyrene Insulation.

GENERAL

- Berth: 6
- Length: 68'
- Year Built: 1980
- Style: Cruiser
- Headroom: Max. 6'2"

COCKPITS/DECKS

- Front: Seating/storage.
- Back: Spacious cruiser-style back deck.

BATHROOM

- Cassette toilet, separate shower, vanity sink and cabinet.

WATER/GAS SYSTEM

- Integral steel 150 gallon water tank.
- Gas system for oven/hob

LIVING/DINING

- Open-plan living and dining area which has been recently refurbished.
- Clean, spacious & light feel to the living area.

KITCHEN/GALLEY

- Lec under-counter 12v fridge/freezer
- Newworld gas hob/oven/grill
- Nicely fitted-out with lots of worktop space

BEDROOMS

- One fixed double with storage.
- Sofa bed in living area.
- Rear cabin with seating which folds into double.

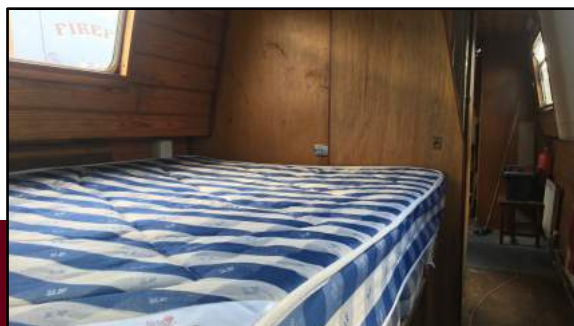

These details are given in good faith but no guarantee is given or implied. Purchasers must satisfy themselves as to the condition and suitability of this vessel. We recommend that a qualified surveyor is employed. The Ashby Canal Centre are agents for this boat on behalf of the owner

