

NIRVANA

FOR SALE

PRICE:
£38,000

52ft
 Semi-Trad Style Narrowboat

2/4 BERTH



BOAT SUMMARY

A 52ft semi-traditional style narrowboat built in 1991 by G.T. Boat Builders. A well-looked after, light, spacious boat which boasts an open plan living/dining area with a modern kitchen and clever storage. Equipped with a Thornycroft engine and a bow thruster.

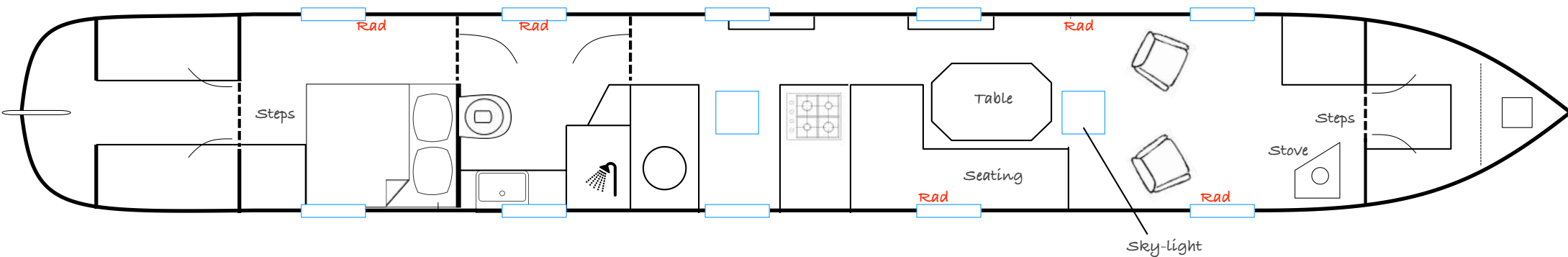

THE ASHBY CANAL CENTRE
 WILLOW PARK
 STOKE GOLDING
 NUNEATON
 WARWICKSHIRE
 CV13 6EU

BRIDGE 26, THE ASHBY CANAL

CONTACT US FOR A VIEWING
01455 212636

SPECIFICATIONS

www.ashbycanalcentre.co.uk

TECHNICAL

- Built in 1991 by G.T. Boat Builders in Stafford
- Thornycroft (Mitsubishi) Engine
- Bow Thruster
- 12 volt system: 1 starter, 4 domestic and 1 bow thruster battery
- 240V Victron Inverter
- Battery Charger
- LEDs throughout

MAINTENANCE HISTORY

- Hull blacking: 2015
- Windows resealed 2015

HEATING/INSULATION

- Morso Squirrel Stove in saloon.
- Alde Compact 3010 water boiler

GENERAL

- Berth: 2/4
- Length: 52'
- Year Built: 1991
- Style: Semi-traditional
- Headroom: Min. 6"2' Max. 6'3"
- Well fitted-out interior

COCKPITS/DECKS

- Front: Seating/storage
- Back: Semi-traditional back deck with cushions
- Cratch with covers at front and rear covers

BATHROOM

- Cassette toilet, shower, sink and cabinet
- Spare cassette

WATER/GAS SYSTEM

- Stainless steel water tank
- Jabsco water system pump
- Gas system for oven/hob

LIVING/DINING

- Open-plan living and dining area including dinette, space for seating, stove and cabinet
- Clever storage throughout the boat and sky-lights which give a more spacious, airy feel to the living area

KITCHEN/GALLEY

- Coolzone under-counter fridge/freezer
- Newworld gas hob/oven/grill
- Modern fit-out

BEDROOMS

- One fixed double with overhead storage
- Dining area turns into bed

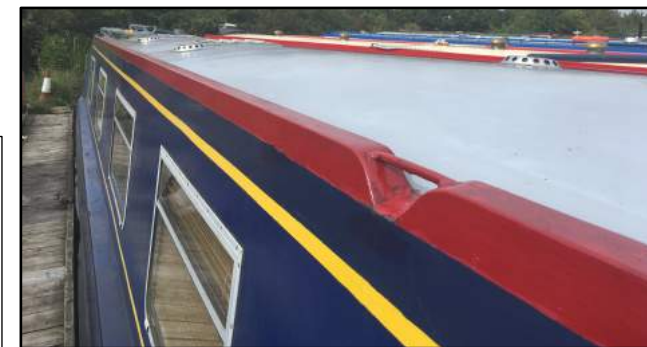

These details are given in good faith but no guarantee is given or implied. Purchasers must satisfy themselves as to the condition and suitability of this vessel. We recommend that a qualified surveyor is employed. The Ashby Canal Centre are agents for this boat on behalf of the owner



THE
ASHBY
CANAL
CENTRE

