

# PERSUASION

# FOR SALE

PRICE:  
**£32,495**

---

55ft  
 Cruiser Style Narrowboat

**4 BERTH**



## BOAT SUMMARY

A 55ft cruiser-style narrowboat built in 1990 by R&D Fabrications. Equipped with a Ford diesel 1.8 engine and including all cruising gear, Persuasion boasts an open-plan kitchen/diner, bedroom with en-suite toilet and new deckboards, batteries and back canopy.

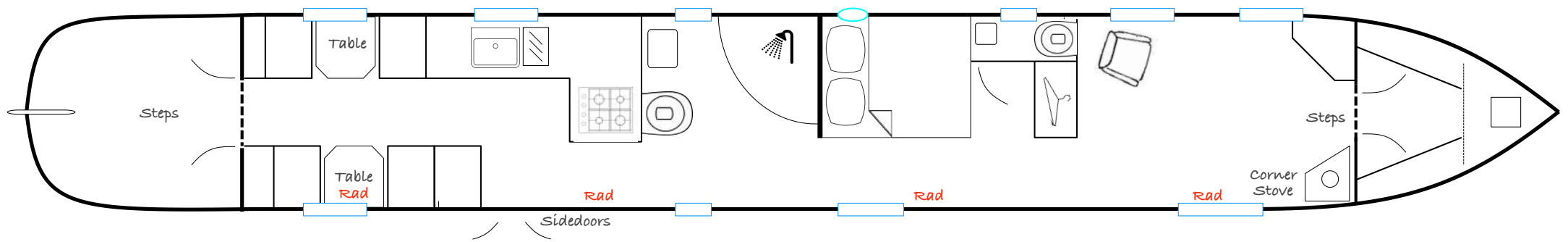

THE ASHBY CANAL CENTRE  
 WILLOW PARK  
 STOKE GOLDING  
 NUNEATON  
 WARWICKSHIRE  
 CV13 6EU

BRIDGE 26, THE ASHBY CANAL

CONTACT US FOR A VIEWING  
**01455 212636**

# SPECIFICATIONS

[www.ashbycanalcentre.co.uk](http://www.ashbycanalcentre.co.uk)

## TECHNICAL

- Built in 1990 and extended by 10ft in 1996.
- Ford Diesel 1.8 Engine.
- 12 volt system: 1 starter & 5 domestic batteries.
- Sterling DC - AC inverter.
- Includes all cruising gear.

## MAINTENANCE HISTORY

- Extended by 10ft in 1996.
- BSC: 2015
- Hull blacking: July 2014
- New domestic batteries 2017.
- New back deckboards 2017.
- New back cover 2016.
- Full professional re-paint 2014.

## HEATING/INSULATION

- Well-used stove with tiled surround.
- Radiators throughout the boat (calorifier in engine bay.)

## GENERAL

- Berth: 4
- Length: 55'
- Year Built: 1990
- Style: Cruiser
- Headroom: Min. 6'2' Max. 6'3".
- Good use of hardwood throughout.

## COCKPITS/DECKS

- Front: Seating/storage.
- Back: Spacious cruiser style back deck.

## BATHROOM

- Cassette toilet, sink and small cabinet.
- Shower over corner-bath.
- Separate en-suite with pump-out toilet & sink.

## WATER/GAS SYSTEM

- 12V water pump
- Gas system for oven/hob.
- Gas bottles at front

## LIVING/DINING

- Open-plan kitchen diner (seating turns into two single beds.)
- Living area at front of boat with TV cabinet, storage and stove.

## KITCHEN/GALLEY

- Sovereign fridge
- Valor gas hob & oven.
- Sink with drainer.
- Side-doors

## BEDROOMS

- One fixed double with overhead storage, ensuite toilet
- Wardrobe with drawers.
- Dining area turns into two single beds.

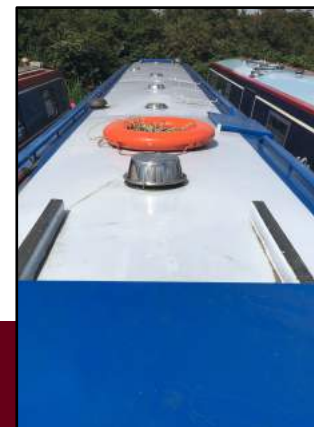
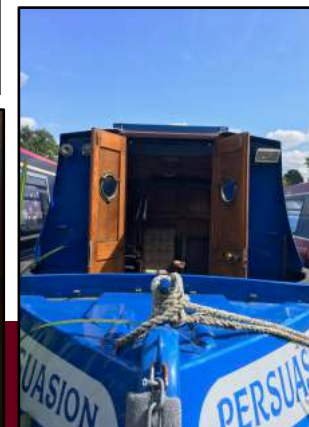

These details are given in good faith but no guarantee is given or implied. Purchasers must satisfy themselves as to the condition and suitability of this vessel. We recommend that a qualified surveyor is employed. The Ashby Canal Centre are agents for this boat on behalf of the owner

